

# uni Flex Plastic Chain

Series **uni 2600** Type **O**

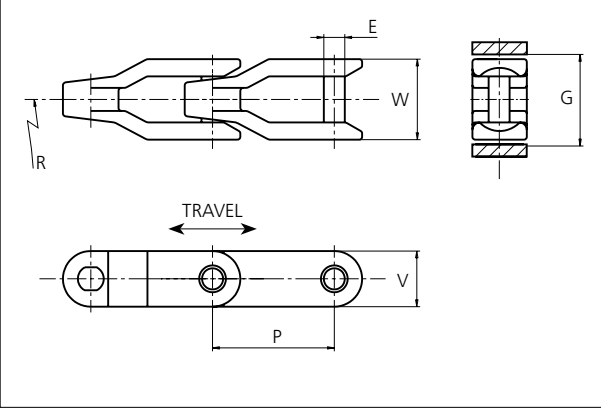

**uni Flex Chains**  
 Side flexing chain  
 Pitch: 63.5 mm (2.50 in)  
 Backflex radius: 75.0 mm (3.00 in)  
 Permissible tensile strength:  
 POM material: 6000 N (1349 lbf)  
  
 Delivery: 6.1 m (20.0 ft)  
 No. of links/box: 96

E		G		P		V	
mm	in	mm	in	mm	in	mm	in
11.0	0.43	44.5	1.75	63.5	2.50	28.4	1.12

All dimensions are for chains in POM material.

Width (W)		Material & color	Pin material	Weight		Min. radius (R)	
mm	in			kg/m	lb/ft	mm	in
42.0	1.65	POM-D <b>W</b> <b>G</b> <b>B</b>	<b>SS304</b>	1.3	0.87	600	23.62

Non standard material and color: See uni Material and Color Overview.  
 Non standard pin material: See uni Material and Color Overview.

STANDARD

SIDE FLEXING

PITCH 63.5 MM/2.50 IN



## Sprocket

No of teeth	Pitch diameter		Overall-diameter		Min. $\phi$ bore		Max. $\phi$ bore		Hub-diameter		A-dimension		B-dimension		PA66	Cast iron	SS304
	mm	in	mm	in	mm	in	mm	in	mm	in	mm	in	mm	in	Molded	Molded	Machined
<b>Z6</b>	127.0	5.00	128.0	5.04	20.0	0.79	40.0	1.57	63.0	2.48	40.8	1.61	78.1	3.07	x	x	
<b>Z8</b>	165.9	6.53	168.9	6.65	20.0	0.79	50.0	1.97	73.5	2.89	62.5	2.46	97.5	3.84	x	x	x
<b>Z10</b>	205.5	8.09	210.5	8.29	20.0	0.79	50.0	1.97	73.5	2.89	83.5	3.29	117.2	4.61	x	x	
<b>Z11</b>	225.4	8.87	231.4	9.11	20.0	0.79	50.0	1.97	73.5	2.89	93.9	3.70	127.1	5.00	x	x	

Non standard material and color:  
See uni Material and Color Overview.

**Machined sprocket**



**Cast iron sprocket**



**SS304 sprocket**

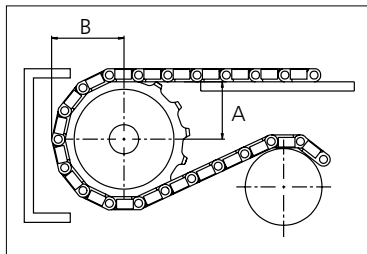

Please ensure that sufficient size shaft and keyway are chosen for corresponding load.

Other sprocket sizes are available upon request

Width of tooth: 11.0 mm/0.43 in

Width of sprocket: 42.3 mm/1.66 in

uni Retainer Rings: See uni Retainer Ring data sheet