

uni Flex Plastic Chain

Series **uni 3000** Type -

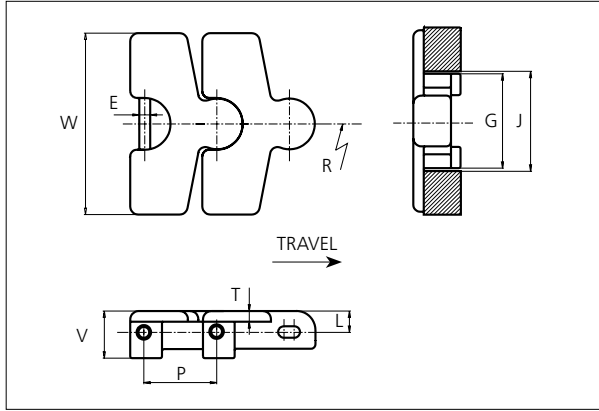

uni Flex Plastic Chain
 Side flexing chain
 Pitch: 80.1 mm (3.15 in)
 Backflex radius:
 200.0 mm (8.00 in)
 Permissible tensile strength:
 POM material
 11000 N (2473 lbf)

 Standard shipping lengths:
 boxes of 38 links
 = 3.044 m (10.0 ft)

NON STANDARD

E		G		J		L		P		T		V	
mm	in	mm	in	mm	in	mm	in	mm	in	mm	in	mm	in
12.1	0.48	104.0	4.09	110.0	4.33	28.4	1.12	80.1	3.15	9.0	0.35	52.0	2.05

All dimensions are for chains in POM material.

Width (W)		Recommended Material & color	Recommended Pin material	Weight		Min radius R	
mm	in			kg/m	lb/ft	mm	in
200.0	7.87	POM-D W POM-D G	SS304	5.8	3.90	600.0	23.62

Non standard material and color: See uni Material and Color Overview.



Non standard pin material: See uni Material and Color Overview.

SIDE FLEXING

PITCH 80.1 MM/3.15 IN



Sprocket

No of teeth	Pitch diameter		Overall-diameter		Min. ϕ bore		Max. ϕ bore		Hub-diameter		Dimension A		Dimension B		 Machined PAG
	mm	in	mm	in	mm	in	mm	in	mm	in	mm	in	mm	in	
Z10	226.4	8.91	227.6	8.96	20.0	0.79	50.0	1.97	73.5	2.89	116.0	4.57	137.6	5.42	

Non standard material and color:
See uni Material and Color Overview.

Machined sprocket

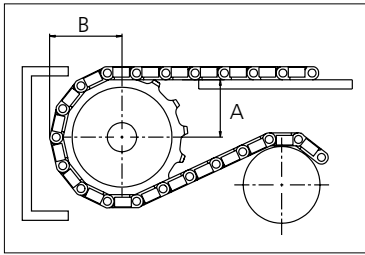

Please ensure that sufficient size shaft and keyway are chosen for corresponding load.

Other sprocket sizes are available upon request
 Width of tooth: 15.0 mm/0.60 in
 Width of sprocket: 42.3 mm/1.66 in
 uni Retainer Rings: See uni Retainer Ring data sheet