

SLIP-ON PROFILES

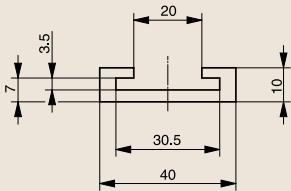

Rail profile	Length	Production method	Original Material "S"®	Article no.	Availability
Plastic C profile for flat steel, 30 x 3	2000	Milled	Green	211 310 016	●
Plastic C profile for flat steel, 30 x 3	2000	Milled	Black antistatic	211 310 020	●
Plastic C profile for flat steel, 30 x 3	2000	Extruded	Green	211 310 024	●
Plastic C profile for flat steel, 40 x 8	2000	Milled	Green	211 310 014	●
Plastic C profile for flat steel, 40 x 8	2000	Milled	Black antistatic	211 310 018	●
Plastic C profile for flat steel, 40 x 8	3000	Extruded	Black	211 310 025	●
Plastic C profile for flat steel, 40 x 10	2000	Milled	Green	211 310 022	●
Plastic C profile for flat steel, 40 x 10	2000	Milled	Black antistatic	211 310 023	●
Plastic C profile for flat steel, 40 x 10	2000	Extruded	Black	211 310 021	●
Plastic C profile for flat steel, 50 x 6	2000	Milled	Green	211 310 013	●
Plastic C profile for flat steel, 50 x 6	2000	Milled	Black antistatic	211 310 017	●
Plastic C profile for flat steel, 50 x 6	3000	Extruded	Natural	211 310 026	○
Plastic C profile for flat steel, 40 x 8	2000	Milled	Green	211 310 015	●
Plastic C profile for flat steel, 40 x 8	2000	Milled	Black antistatic	211 310 019	●

For flat steel, 30 x 3
milled/extruded



For flat steel, 40 x 8
milled

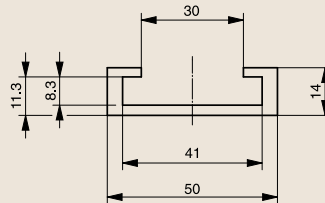

For flat steel, 40 x 8
extruded

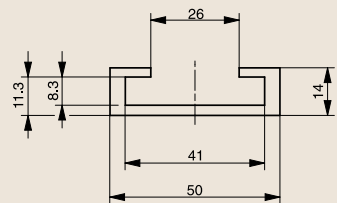

For flat steel, 40 x 10
milled

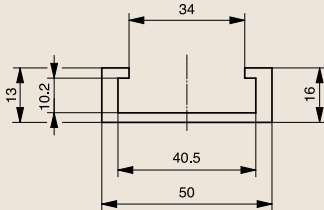

For flat steel, 40 x 10
extruded

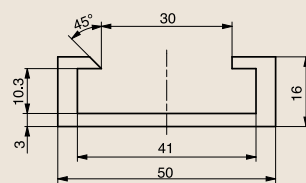

For flat steel, 50 x 6
milled

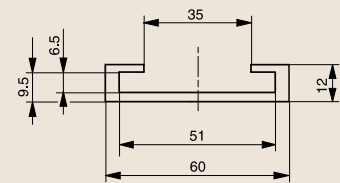

For flat steel, 50 x 6
extruded

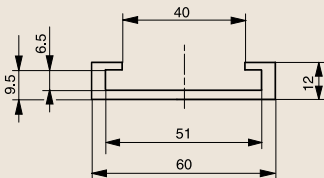

Plastic L profile
For flat steel, 40 x 8
milled

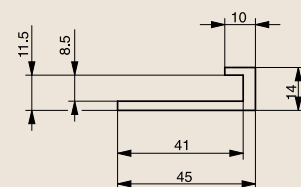

● Stocked ○ Available within 10 days Dimensions in mm Extruded profiles made of Material "S"® Black are **not** antistatic.

* For milled profiles. Tolerances as per DIN 16941 for extruded profiles.